

CHAPTER 76

ENGINE CONTROLS

<i>Figure</i>	<i>Title</i>	<i>Page</i>
76-1	Fuel Control Unit Controls Installation	76.0
76-5	Power Turbine Governor Control Installation	76.4
76-7	Actuator Assembly Installation	76.6

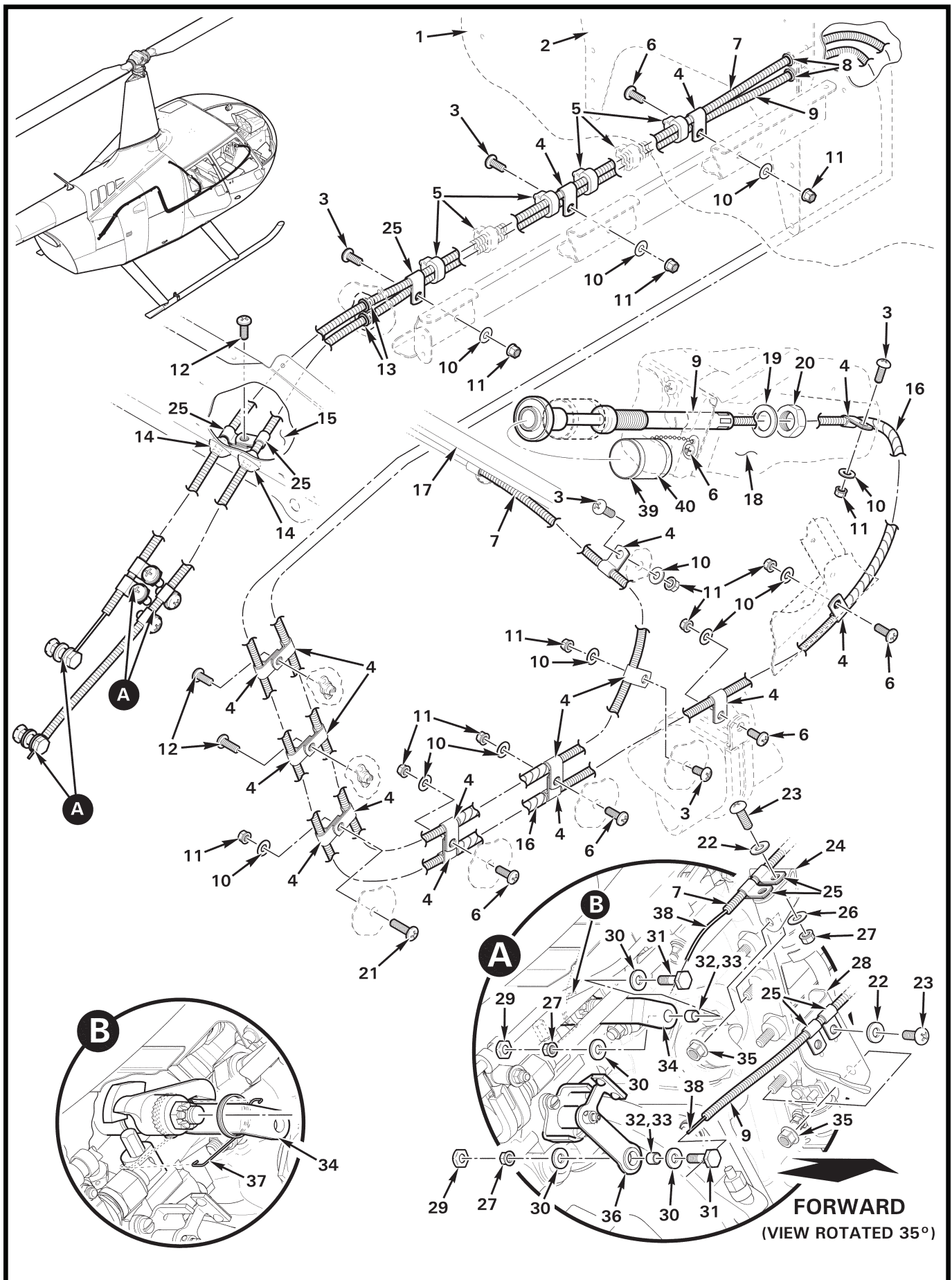

FIGURE AND INDEX NUMBER	PART NUMBER	DESCRIPTION	PARTS AVAIL	QTY PER ASSY
FUEL CONTROL UNIT CONTROLS INSTALLATION				
76-1-1	G259-1	Panel (Bulkhead; Ref)		
2	F386-2	Panel (Ref)		
3	MS27039C0806	Screw	X	5
4	AN742-3	Clamp	X	17
5	MS3367-7-9	Ty-rap (around items 7 and 9, [6 places])	X	6
6	MS27039C0807	Screw	X	6
7	C522-10	Control – Throttle (Incl item 38; see also Figure 67-21)	X	1
8	NAS557-4B	Grommet	X	2
9	A522-10	Control – Fuel Cutoff (Incl items 19, 20, and 38)	X	1
10	NAS1149FN816P	Washer	X	11
11	MS21042L08	Nut	X	11
12	MS27039C0808	Screw	X	3
13	NAS557-4A	Grommet (install using item 14)	X	2
14	B270-5	Sealant	X	A/R
15	G023-1	Ceiling Assembly – Baggage Compartment (Ref)		
16	B161-4	Spirap (2 places)	X	A/R
17	F758-1	Collective Stick Assembly (Ref, see Figure 67-21)		
18	F359-2	Panel (Ref)		
19	—	Washer	O	1
20	—	Nut	O	1
21	MS27039C0809	Screw	X	1
22	NAS1149F0363P	Washer	X	4
23	MS27039C1-08	Screw	X	4
24	F577-3	Bracket	X	1
25	AN742-4	Clamp	X	7
26	NAS1149F0332P	Washer	X	2
27	D210-3	Nut	X	3
28	F577-1	Bracket	X	1
29	B330-7	Palnut	X	2
30	C141-26	Washer	X	4
31	A462-4	Fitting	X	2
32	A130-48	Spacer (install using item 33)	X	2
33	A257-1	Grease	X	A/R
34	—	Throttle Arm (Ref)		
35	—	Nut (Ref)		

NOTES

Continues

FIGURE AND INDEX NUMBER	PART NUMBER	DESCRIPTION	PARTS AVAIL	QTY PER ASSY
		FUEL CONTROL UNIT CONTROLS INSTALLATION (Cont'd)		
76-1-36	—	Fuel Cutoff Arm (Ref)		
37	D930-2	Spring	X	1
38	SSW-050-C522-10	Inner Wire	X	2
39	A950-3	Guard Assembly – Fuel Cutoff Control (Incl item 40)	X	1
40	A654-45	Decal – "FUEL CONTROL..."	X	1
NOTES				

Intentionally Blank

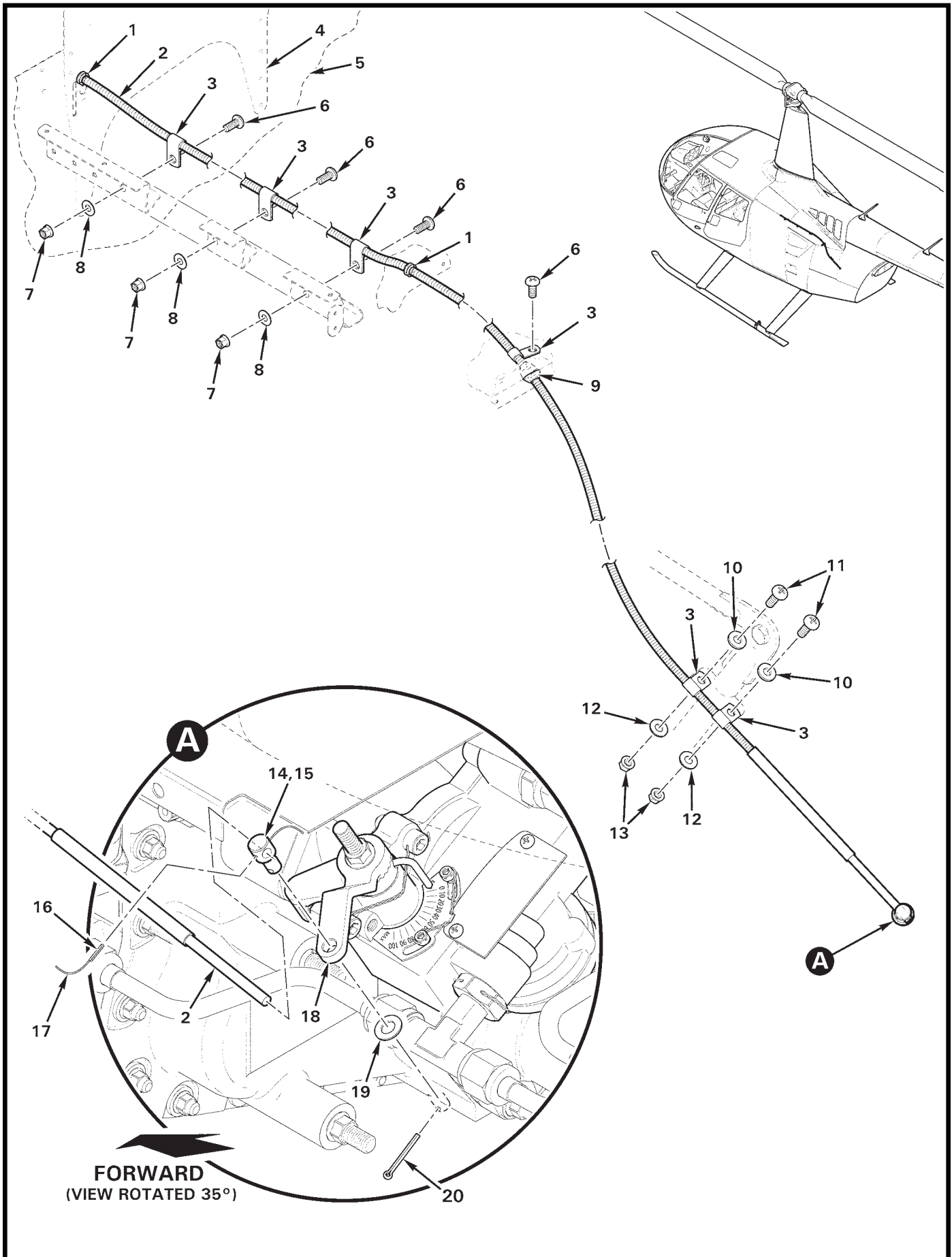

FIGURE AND INDEX NUMBER	PART NUMBER	DESCRIPTION	PARTS AVAIL	QTY PER ASSY
POWER TURBINE GOVERNOR CONTROL INSTALLATION				
76-5-1	NAS557-4A	Grommet	X	1
2	C522-11	Control (Power Turbine Governor)	X	1
3	AN742-3	Clamp	X	6
4	F386-2	Cover (Ref)		
5	G259-1	Panel (Bulkhead; Ref)		
6	MS27039C0806	Screw	X	4
7	MS21042L08	Nut	X	3
8	NAS1149FN816P	Washer	X	3
9	B270-5	Sealant	X	A/R
10	NAS1149F0363P	Washer	X	2
11	MS27039C1-08	Screw	X	2
12	NAS1149F0332P	Washer	X	2
13	MS21042L3	Nut	X	2
14	D333-13	Fitting (install using item 15)	X	1
15	A257-1	Grease	X	A/R
16	MS16562-4	Spring Pin	X	1
17	MS20995C20	0.020 in. dia Safety Wire	X	A/R
18	—	Power Turbine Governor Input Lever (Ref)		
19	NAS1149F0432P	Washer	X	1
20	MS24665-210	Cotter Pin	X	1

NOTES

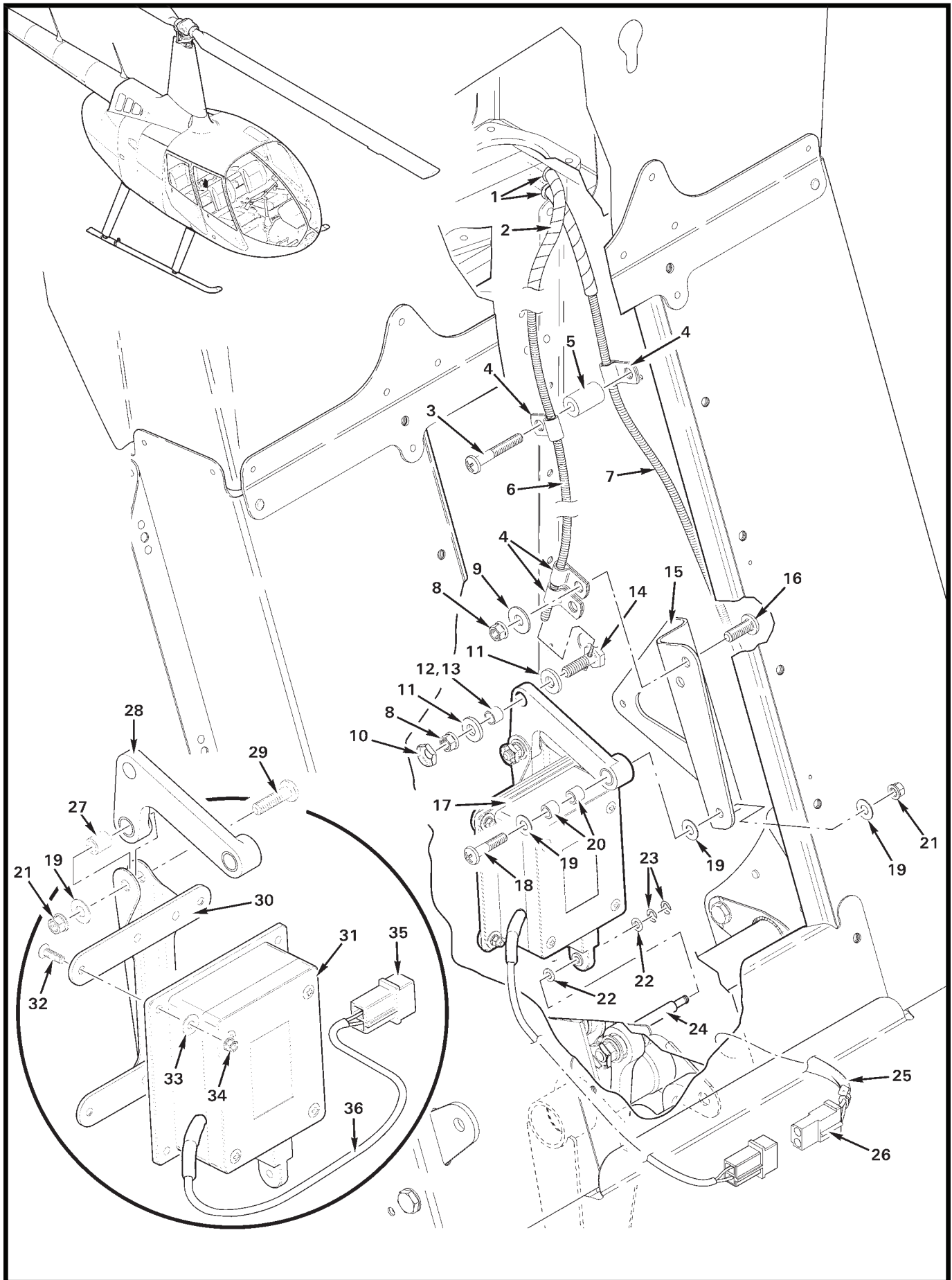

FIGURE AND INDEX NUMBER	PART NUMBER	DESCRIPTION	PARTS AVAIL	QTY PER ASSY
ACTUATOR ASSEMBLY INSTALLATION				
76-7-1	NAS557-4A	Grommet	X	2
2	B161-4	Spirap	X	A/R
3	MS27039C0817	Screw	X	1
4	AN742-3	Clamp	X	4
5	A130-50	Spacer	X	1
6	C522-11	Control (actuator)	X	1
7	A522-11	Control (fuel shutoff; Ref)		
8	MS21042L3	Nut	X	3
9	NAS1149F0332P	Washer	X	2
10	B330-7	Palnut	X	1
11	NAS1149E0363R	Washer	X	2
12	A130-48	Spacer (install using item 13)	X	1
13	A257-1	Grease	X	A/R
14	A462-4	Fitting	X	1
15	F381-6	Bracket (Ref)		
16	MS27039C1-08	Screw	X	2
17	F334-2	Actuator Assembly (Incl items 8, 10 thru 14, 18, 20 thru 23, and 27 thru 34)	X	1
18	MS27039C0812	Screw	X	1
19	NAS1149FN816P	Washer	X	3
20	A105-7	Journal	X	2
21	MS21042L08	Nut	X	1
22	NAS620-5	Washer	X	2
23	MS16633-2012	Retainer Ring	X	2
24	F334-1	Support Assembly (Ref)		
25	F059	Wire Harness (cabin electrical; Ref)		
26	B263-13	Housing	X	1
	B263-2	Socket	X	2
27	A105-5	Journal	X	1
28	F822-1	Bellcrank Assembly	X	1
29	MS27039C0810	Screw	X	1
30	F821-1	Arm Assembly	X	1
31	F820-1	Actuator Assembly (Incl items 35 and 36)	X	1
32	MS24693-S4	Screw	X	4
33	NAS1149FN416P	Washer	X	4

NOTES

Continues

FIGURE AND INDEX NUMBER	PART NUMBER	DESCRIPTION	PARTS AVAIL	QTY PER ASSY
ACTUATOR ASSEMBLY INSTALLATION (Cont'd)				
76-7-34	MS21042L04	Nut	X	1
35	B263-12	Housing	X	1
	B263-1	Pin	X	2
36	B158-2	Heat Shrink	X	A/R

NOTES