

R44-series Intercom Floor Switch Relocation Kit Instructions

Kit converts intercom floor switch to push button switch, and relocates to outboard side of co-pilot seat. Eligible for installation on R44 S/N 2420 & prior and R44 II S/N 13902 & prior.

NOTE

Visit www.robinsonheli.com to verify kit instructions are current revision. Review instructions before installation; contact RHC Technical Support with questions. Verify kit contents match list; contact RHC Customer Service if parts are missing or damaged.

ITEM	PART NUMBER	KIT CONTENTS	QTY
1	KI-289-2Instr.	Kit Instructions	1
2	B263-2	Socket	3
3	B263-13	Housing (2-socket)	1
4	C049-18	Harness Assembly (supplied with B263-12 housing)	1
5	G1042	Grommet	1
6	N-3-BK	Clamp	1
7	N-4-BK	Clamp	2
8	MS21042L06	Nut	2
9	MS21042L08	Nut	1
10	MS27039C0806	Screw	2
11	MS3367-4-9+	Ty-Rap (Note: "+" in contents part number indicates 20-qty pack)	1
12	MS3367-5-0+	Ty-Rap (Note: "+" in contents part number indicates 10-qty pack)	1
13	MS35206-228+	Screw (Note: "+" in contents part number indicates 10-qty pack)	1
14	NAS1149FN616P+	Washer (Note: "+" in contents part number indicates 20-qty pack)	1
15	NAS1149FN816P+	Washer (Note: "+" in contents part number indicates 20-qty pack)	1

Consumables

Refer to R44 Maintenance Manual (MM) § 23-70 for approved materials list.

- B270-8 Adhesive

Special Tools

- Wire stripping and crimping tools

Kit Instructions

1. Turn BATTERY switch OFF. Disconnect battery per MM § 37-10.
2. Refer to MM Figure 2-4. Remove items 3A, 3B, 3C and 3E. Open circuit breaker panel.
3. Refer to Figure 1. Layout hole locations on C297-5 LH support assembly as shown. Verify adequate clearance on reverse side. Using a drill stop, drill (3) 0.139–0.149 inch diameter holes and 0.20–0.30 inch diameter hole (View A-A). Create oblong hole as shown (Detail -B-).

Kit Instructions (continued)

4. Refer to Figure 2. Lay out dimensions on C492-5 guard. Verify adequate clearance on reverse side. Using a drill stop, drill 0.370–0.380 inch diameter hole.
5. Deburr all newly drilled holes and clean up debris. At installer's discretion, alodine and/or prime/paint hole(s) as described in note below.

NOTE

After trimming or filing aluminum, finish edges as follows: Deburr trimmed edges with 220-grit or finer wet-or-dry aluminum oxide abrasive paper. Solvent-clean deburred edge and apply Bonderite M-CR 1132, or Bonderite M-CR 1201 Aero in accordance with manufacturer's instructions. Apply epoxy primer to dry edge. Touch up with helicopter paint color, where applicable, is optional.

6. Refer to IPC Figure 25-29. Carefully remove C469 LH (fwd) carpet assembly per MM § 15.310 or 15-320.

NOTE

Parenthetic dash numbers, such as (-283), indicate number marked on wiring insulation (if single conductor), or jacket (if multi-conductor and/or shielded).

7. Refer to Figure 3. Remove installation hardware securing A797-1 cover and B565-1 switch. Retain hardware and cover. Trim wires (-283) & (-284), leaving ring terminals on switch; remove and discard switch.
8. Install A797-1 cover on floor panel using retained hardware.
9. Refer to Figure 4. Carefully remove ty-raps from airframe harness and route wires (-283) & (-284) to the circuit breaker compartment. Strip wires (-283) & (-284) and crimp B263-2 socket onto each wire. Inspect crimp per MM § 23-84. Verify security of socket. Insert sockets into B263-13 housing. Verify security of socket in housing. Secure wires using appropriately sized ty-raps. Cinch ty-raps until snug without over-tightening, and trim tip flush with head.
10. Install G1042 grommet on newly drilled hole on C492-5 guard and route C049-18 harness through G1042 grommet as shown. Insert harness assembly pins into B263-12 housing (supplied with harness). Verify security of pins in housing.
11. Connect C049-18 harness and B263-13 housings. Route harness along edge of C297-5 support assembly as shown. Install N-3-BK clamp, (2) N-4-BK clamps and appropriately sized ty-rap as shown. Cinch ty-raps until snug without over-tightening, and trim tip flush with head.
12. Remove cap and dress nut from switch. Install switch assembly through newly drilled hole on C297-5 support assembly. Secure switch assembly using dress nut and cap.
13. Install LH floor carpet per MM § 15-310 or 15.320.
14. Close and secure circuit breaker panel. Install access and inspection panels, as required.
15. Verify proper operation of co-pilot intercom switch.
16. Make appropriate maintenance record entries. Weight and Balance change is negligible.

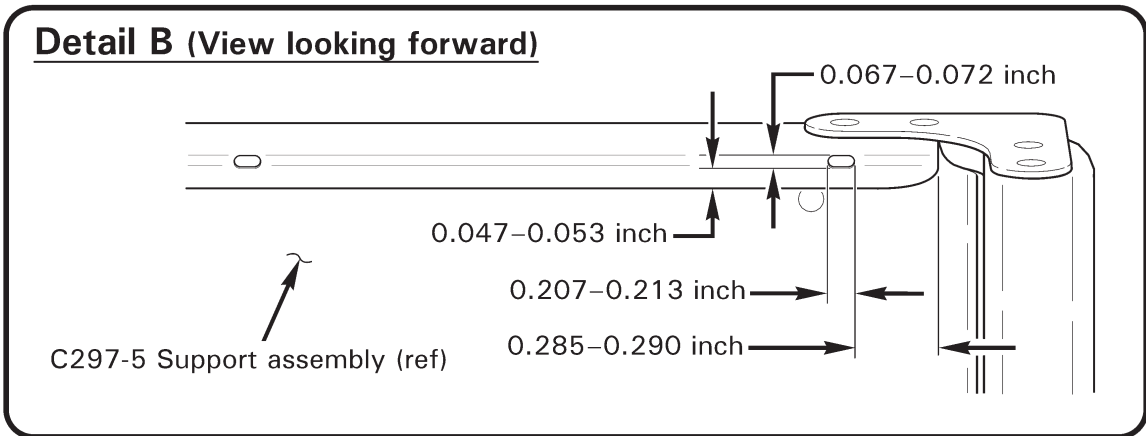
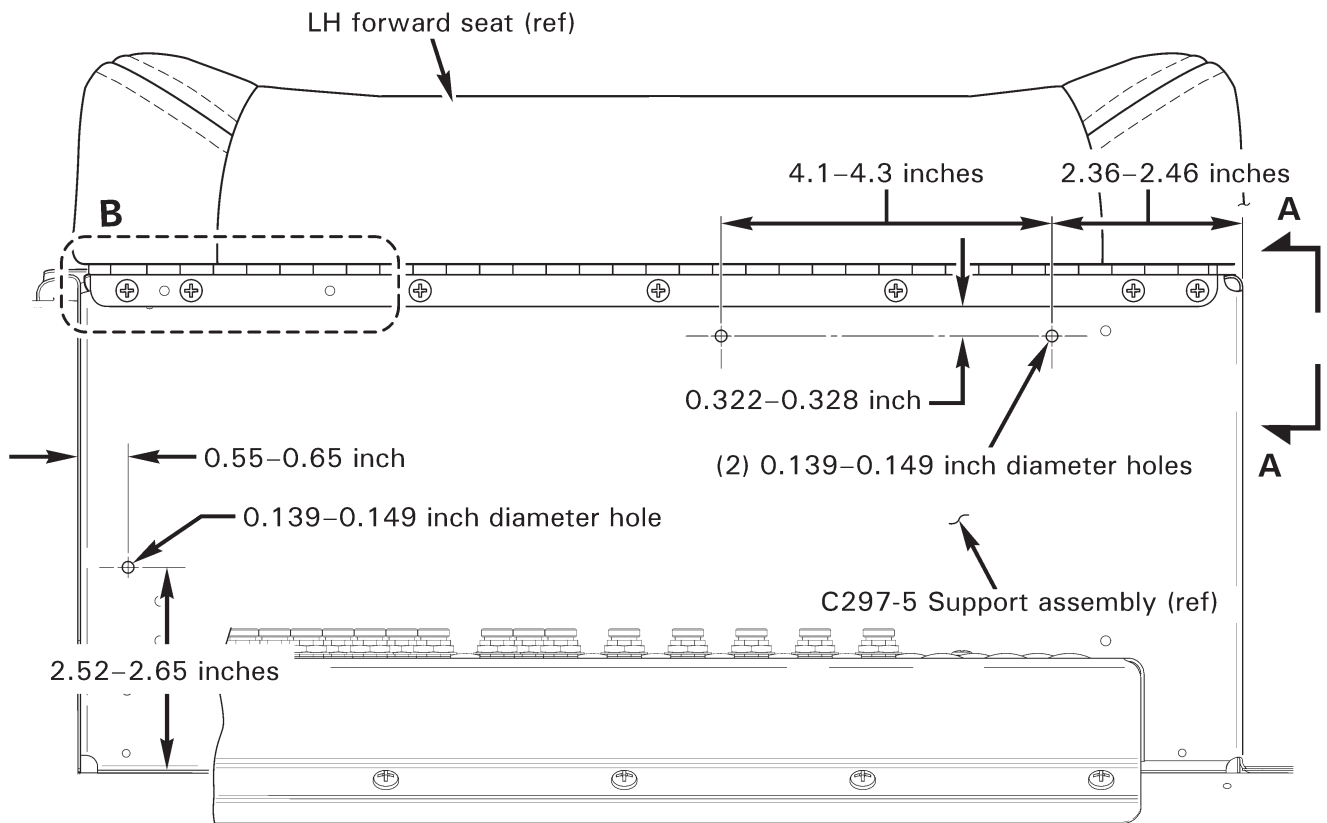
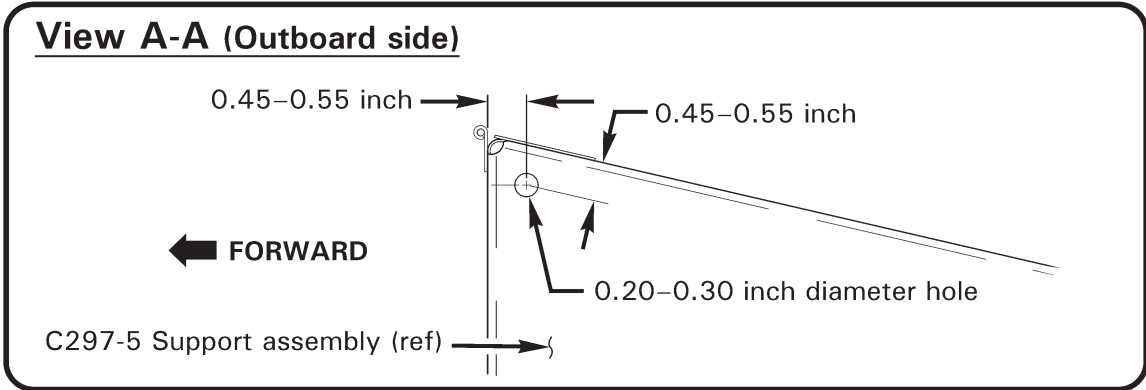

Figure 1 Co-pilot seat drilling location

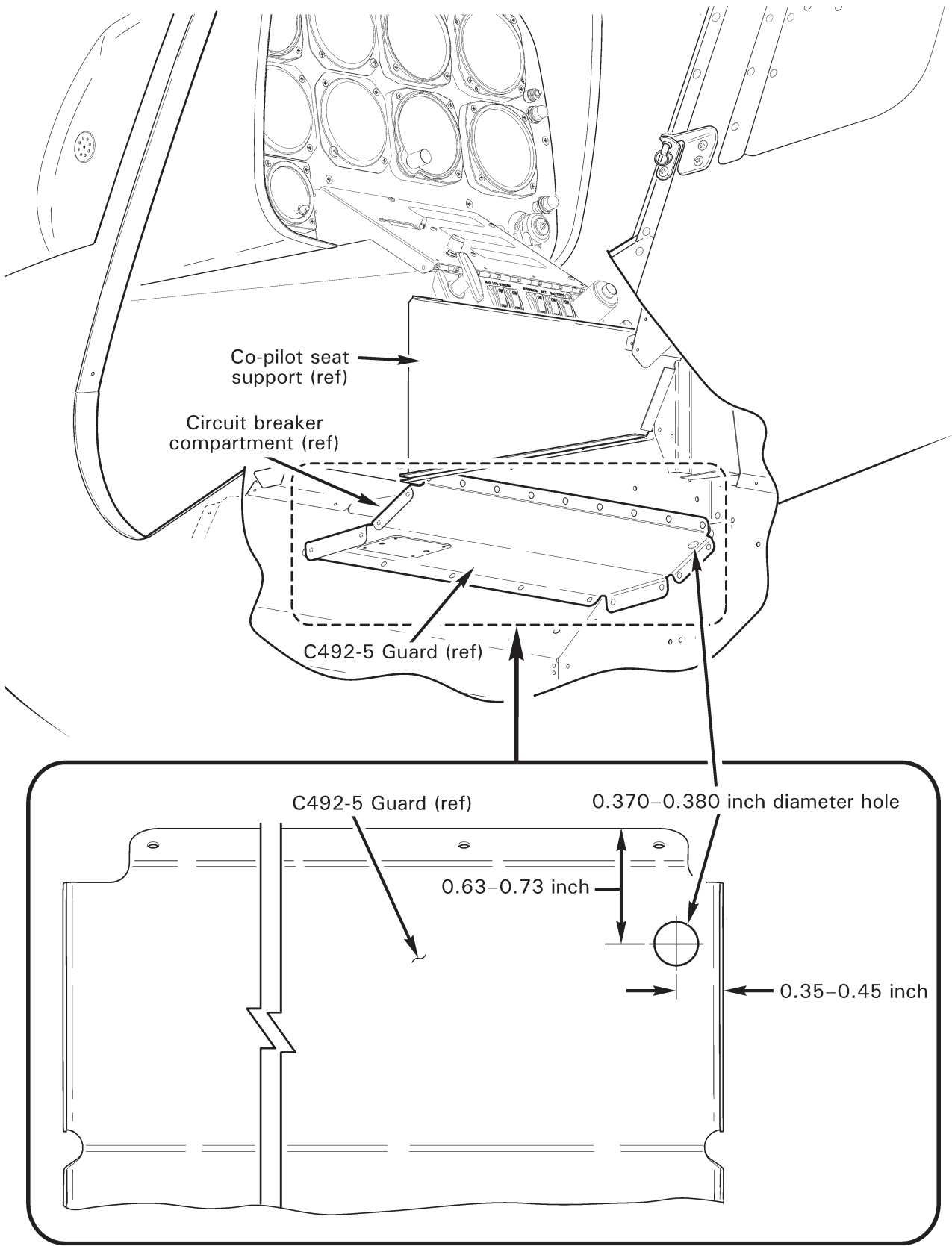

Figure 2 C492-5 Guard drill location
(view looking inboard, under circuit breaker)

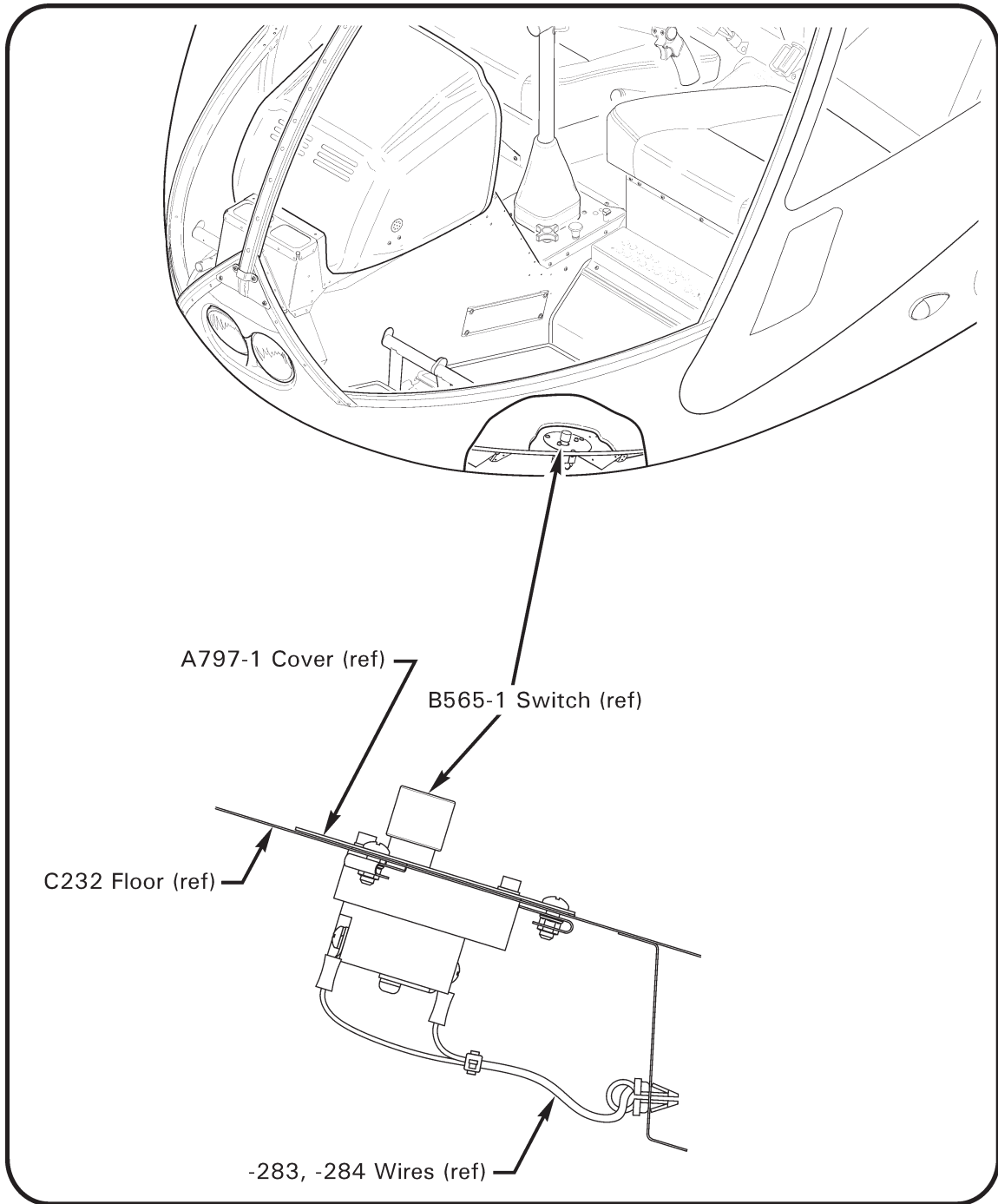

Figure 3 B565-1 Switch location

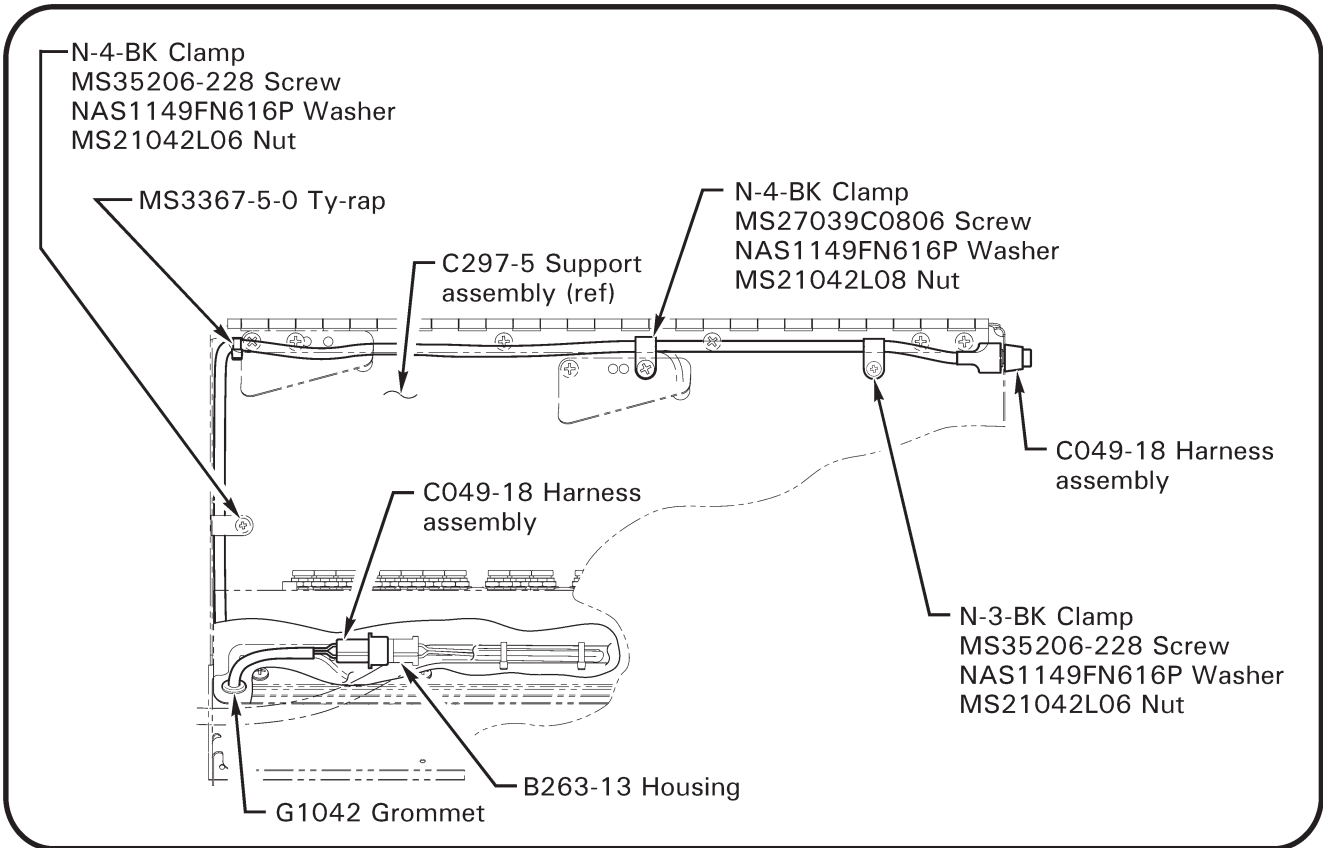
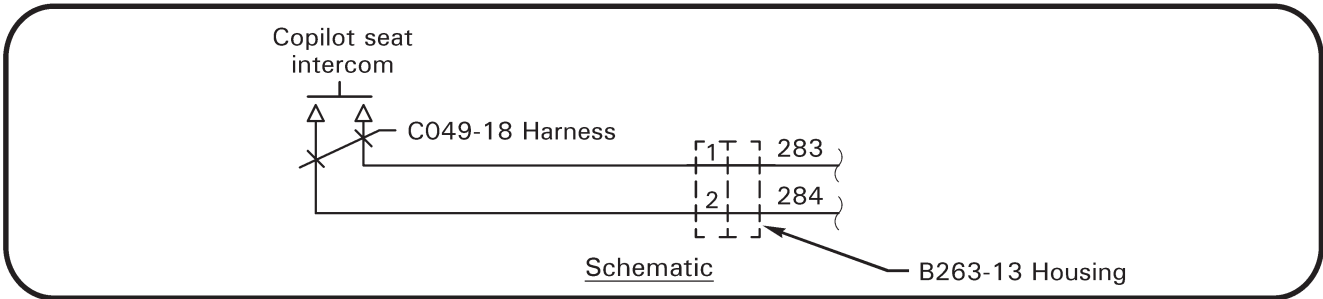

Figure 4 Intercom switch installation
(view looking aft)