

CHAPTER 32  
LANDING GEAR

| <i>Figure</i> | <i>Title</i>                                          | <i>Page</i> |
|---------------|-------------------------------------------------------|-------------|
| 32-1          | Landing Gear Assembly . . . . .                       | 32.0        |
| 32-5          | Landing Gear Assembly . . . . .                       | 32.4        |
| 32-9          | Fixed Floats – Tube Assemblies Installation . . . . . | 32.8        |



| FIGURE AND INDEX NUMBER      | PART NUMBER   | DESCRIPTION                                                                           | PARTS AVAIL | QTY PER ASSY |
|------------------------------|---------------|---------------------------------------------------------------------------------------|-------------|--------------|
| <b>LANDING GEAR ASSEMBLY</b> |               |                                                                                       |             |              |
| 32-1-1                       | A014-19       | Landing Gear Assembly (Incl items 2, 18, 19, 25, 27, 32 thru 36, 38 and 45) . . . . . | X           | 1            |
| 2                            | A241-3        | Cross Tube (Incl item 22 [2 each]) . . . . .                                          | X           | 2            |
| 3                            | D210-3        | Nut . . . . .                                                                         | X           | 4            |
| 4                            | NAS620-10L    | Washer . . . . .                                                                      | X           | 8            |
| 5                            | A354-2        | Block . . . . .                                                                       | X           | 1            |
| 6                            | NAS1149F0632P | Washer . . . . .                                                                      | X           | 6            |
| 7                            | NAS6606-49    | Bolt (or NAS6606-50) . . . . .                                                        | X           | 1            |
| 8                            | NAS6603-18    | Bolt . . . . .                                                                        | X           | 4            |
| 9                            | A391-1        | Doubler (Ref)                                                                         |             |              |
| 10                           | A350-4        | Panel – RH (Ref)                                                                      |             |              |
| 11                           | D210-6        | Nut . . . . .                                                                         | X           | 5            |
| 12                           | A214-2        | Washer . . . . .                                                                      | X           | 2            |
| 13                           | A214-9        | Thrust Washer . . . . .                                                               | X           | 2            |
| 14                           | A105-4        | Journal . . . . .                                                                     | X           | 1            |
| 15                           | A014-5        | Shackle Assembly . . . . .                                                            | X           | 1            |
| 16                           | LJS-0816      | Bearing . . . . .                                                                     | X           | 2            |
| 17                           | A141-9        | Washer . . . . .                                                                      | X           | 1            |
| 18                           | A243-6        | Spacer . . . . .                                                                      | X           | 4            |
| 19                           | A239-4        | Strut Assembly . . . . .                                                              | X           | 4            |
| 20                           | A141-23       | Washer . . . . .                                                                      | X           | 8            |
| 21                           | NAS6606-42    | Bolt (or NAS1306-42) . . . . .                                                        | X           | 4            |
| 22                           | A247-3        | Rain Cap (install using item 46) . . . . .                                            | X           | 4            |
| 23                           | A046-1        | Frame Assembly – Lower (LH; Ref, see Figure 53-9)                                     |             |              |
|                              | A046-2        | Frame Assembly – Lower (RH; Ref, see Figure 53-9)                                     |             |              |
| 24                           | NAS6604-15    | Bolt . . . . .                                                                        | X           | 2            |
| 25                           | NAS1149F0432P | Washer . . . . .                                                                      | X           | 5            |
| 26                           | A354-1        | Block (Ref)                                                                           |             |              |
| 27                           | D210-4        | Nut . . . . .                                                                         | X           | 9            |
| 28                           | A141-11       | Washer . . . . .                                                                      | X           | 8            |
| 29                           | NAS6604-11    | Bolt . . . . .                                                                        | X           | 4            |
| 30                           | A014-6        | Support Assembly (forward) . . . . .                                                  | X           | 1            |
| 31                           | A574-2        | Support Assembly (aft) . . . . .                                                      | X           | 2            |
| 32                           | NAS6605-5     | Bolt (or NAS1305-5) . . . . .                                                         | X           | 16           |
| 33                           | NAS1149F0563P | Washer . . . . .                                                                      | X           | 16           |

NOTES

Continues

| FIGURE AND INDEX NUMBER               | PART NUMBER   | DESCRIPTION                                                                                  | PARTS AVAIL | QTY PER ASSY |
|---------------------------------------|---------------|----------------------------------------------------------------------------------------------|-------------|--------------|
| <b>LANDING GEAR ASSEMBLY (Cont'd)</b> |               |                                                                                              |             |              |
| 32-1-34                               | NAS1149F0463P | Washer . . . . .                                                                             | X           | 4            |
| 35                                    | A719-1        | Support Weldment – Ground Handling Wheel . . . . .                                           | X           | 2            |
| 36                                    | AN4-25A       | Bolt . . . . .                                                                               | X           | 2            |
| 37                                    | A247-1        | Rain Cap (install using item 46) . . . . .                                                   | X           | 1            |
| 38                                    | A014-11       | Skid Tube Assembly (LH; includes A242-3, and items 37, 39 thru 41, 43, 44, and 46) . . . . . | X           | 1            |
|                                       | A014-12       | Skid Tube Assembly (RH; includes A242-4, and items 37, 39 thru 41, 43, 44, and 46) . . . . . | X           | 1            |
|                                       | A242-3        | Skid Tube (LH) . . . . .                                                                     | O           | 1            |
|                                       | A242-4        | Skid Tube (RH) . . . . .                                                                     | O           | 1            |
| 39                                    | A142-3        | Screw ([4] each side) . . . . .                                                              | X           | 8            |
| 40                                    | A142-1        | Screw . . . . .                                                                              | X           | 12           |
| 41                                    | A667-6        | Skid Shoe – Curved . . . . .                                                                 | X           | 2            |
| 42                                    | MS21075L3E    | Nutplate . . . . .                                                                           | X           | 8            |
| 43                                    | A246-5        | Liner (LH, includes item 42, 48 thru 50) . . . . .                                           | X           | 1            |
|                                       | A246-6        | Liner (RH, includes item 42, 48 thru 50) . . . . .                                           | X           | 1            |
|                                       | A246-1        | Liner (no longer available) . . . . .                                                        | O           | 2            |
| 44                                    | A667-5        | Skid Shoe – Straight . . . . .                                                               | X           | 2            |
| 45                                    | A937-1        | Extension (LH) . . . . .                                                                     | X           | 1            |
|                                       | A937-2        | Extension (RH) . . . . .                                                                     | X           | 1            |
| 46                                    | B270-1        | Adhesive . . . . .                                                                           | X           | A/R          |
| 47                                    | NAS1149F0663P | Washer (as required for 2-4 exposed threads) . . . . .                                       | X           | A/R          |
| 48                                    | NAS1097AD4    | Rivet . . . . .                                                                              | X           | 8            |
| 49                                    | A246-3        | Spacer . . . . .                                                                             | X           | 4            |
| 50                                    | MS21075L5E    | Nutplate . . . . .                                                                           | X           | 4            |

NOTES

Intentionally Blank



| FIGURE AND INDEX NUMBER | PART NUMBER    | DESCRIPTION                                                                                                                                                       | PARTS AVAIL | QTY PER ASSY |
|-------------------------|----------------|-------------------------------------------------------------------------------------------------------------------------------------------------------------------|-------------|--------------|
|                         |                | <b>LANDING GEAR ASSEMBLY</b>                                                                                                                                      |             |              |
| 32-5-1                  | A014-8         | Landing Gear Assembly (Incl items 4, 5, 8, 14 thru 20, 22, 23, 25, 26, and 42) . . . . .                                                                          | X           | 1            |
| 2                       | A046-1         | Frame Assembly – Lower (LH; Ref, see Figure 53-9)                                                                                                                 |             |              |
| 3                       | A046-2         | Frame Assembly – Lower (RH; Ref, see Figure 53-9)                                                                                                                 |             |              |
| 4                       | A014-11        | Skid Tube Assembly (LH, revision AI and prior. No longer available; to replace order [1] A014-11 revision AJ and subsequent. See Figure 32-1.) . . . . .          | O           | 1            |
| 5                       | A014-12        | Skid Tube Assembly (RH, revision AI and prior. No longer available; to replace order [1] A014-12 revision AJ and subsequent. See Figure 32-1.) . . . . .          | O           | 1            |
| 6                       | A242-1         | Skid Tube (LH, revision T and prior. See Figure 32-1.) . . . . .                                                                                                  | O           | 1            |
| 7                       | A242-2         | Skid Tube (RH, revision T and prior. See Figure 32-1.) . . . . .                                                                                                  | O           | 1            |
| 8                       | A014-18        | Strut Assembly (No longer available; to replace order [2] A239-4 strut assemblies, and [1] A241-3 cross tube and associated hardware. See Figure 32-1.) . . . . . | O           | 4            |
| 9                       | A246-1         | Liner (superseded by item 51) . . . . .                                                                                                                           | O           | 2            |
| 10                      | A247-1         | Rain Cap (bond in place using item 47) . . . . .                                                                                                                  | X           | 1            |
| 11                      | A667-5         | Skid Shoe – Straight . . . . .                                                                                                                                    | X           | 2            |
| 12                      | A667-6         | Skid Shoe – Curved . . . . .                                                                                                                                      | X           | 1            |
| 13                      | NAS1330H3K116L | Rivnut . . . . .                                                                                                                                                  | X           | 4            |
| 14                      | A719-1         | Support Assembly – Ground Handling Wheel . . . . .                                                                                                                | X           | 2            |
| 15                      | A937-1         | Extension (LH, seal gaps with item 47) . . . . .                                                                                                                  | X           | 1            |
| 16                      | A937-2         | Extension (RH, seal gaps with item 47) . . . . .                                                                                                                  | X           | 1            |
| 17                      | AN4-25A        | Bolt . . . . .                                                                                                                                                    | X           | 2            |
| 18                      | NAS1149F0432P  | Washer . . . . .                                                                                                                                                  | X           | 10           |
| 19                      | NAS1149F0463P  | Washer . . . . .                                                                                                                                                  | X           | 4            |
| 20                      | D210-4         | Nut . . . . .                                                                                                                                                     | X           | 5            |
| 21                      | A142-1         | Screw . . . . .                                                                                                                                                   | X           | 12           |
| 22                      | A278-1         | Spacer (2.030–2.035 inches long) . . . . .                                                                                                                        | X           | 4            |
| 23                      | A241-2         | Cross Tube (Incl item 24 [2]) . . . . .                                                                                                                           | X           | 2            |
| 24                      | A247-3         | Rain Cap (bond in place using item 47) . . . . .                                                                                                                  | X           | 4            |
| 25                      | NAS6605-5      | Bolt . . . . .                                                                                                                                                    | X           | 16           |
| 26                      | NAS1149F0563P  | Washer . . . . .                                                                                                                                                  | X           | 16           |
| 27                      | A014-5         | Shackle Assembly . . . . .                                                                                                                                        | X           | 1            |
| 28                      | A014-6         | Support Assembly (forward) . . . . .                                                                                                                              | X           | 1            |
| 29                      | A014-7         | Support Assembly (aft) . . . . .                                                                                                                                  | X           | 2            |
| 30                      | A105-4         | Journal . . . . .                                                                                                                                                 | X           | 1            |

NOTES

Continues

| FIGURE AND INDEX NUMBER               | PART NUMBER   | DESCRIPTION                               | PARTS AVAIL | QTY PER ASSY |
|---------------------------------------|---------------|-------------------------------------------|-------------|--------------|
| <b>LANDING GEAR ASSEMBLY (Cont'd)</b> |               |                                           |             |              |
| 32-5-31                               | A141-9        | Washer .....                              | X           | 1            |
| 32                                    | A214-1        | Washer .....                              | X           | 8            |
| 33                                    | A214-2        | Washer .....                              | X           | 2            |
| 34                                    | A141-23       | Washer .....                              | X           | 8            |
| 35                                    | A936-2        | Ground Wire Assembly .....                | X           | 1            |
| 36                                    | NAS6606-42    | Bolt .....                                | X           | 4            |
| 37                                    | NAS6606-50    | Bolt .....                                | X           | 1            |
| 38                                    | NAS6604-11    | Bolt .....                                | X           | 3            |
| 39                                    | NAS6604-15    | Bolt .....                                | X           | 2            |
| 40                                    | NAS1149F0632P | Washer .....                              | X           | 2            |
| 41                                    | D210-6        | Nut .....                                 | X           | 5            |
| 42                                    | NAS6604-32    | Bolt .....                                | X           | 4            |
| 43                                    | LJS-0816      | Bearing .....                             | X           | 2            |
| 44                                    | A214-9        | Thrust Washer .....                       | X           | 2            |
| 45                                    | B330-19       | Palnut .....                              | X           | 5            |
| 46                                    | A141-11       | Washer .....                              | X           | 8            |
| 47                                    | B270-1        | Adhesive .....                            | X           | A/R          |
| 48                                    | NAS6604-12    | Bolt (right outboard position only) ..... | X           | 1            |
| NOTES                                 |               |                                           |             |              |



Intentionally Blank

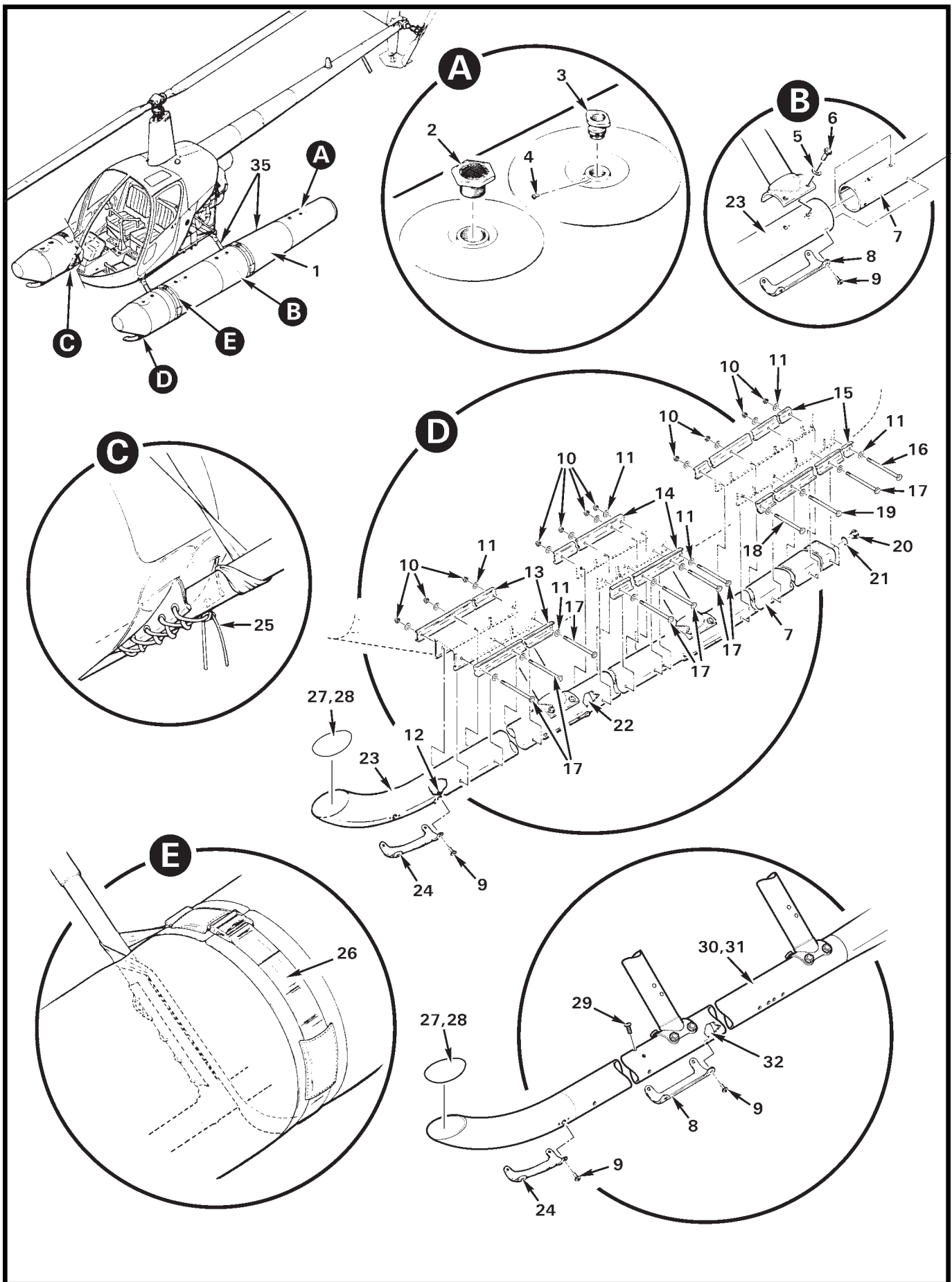

| FIGURE AND INDEX NUMBER | PART NUMBER     | DESCRIPTION                                                                  | PARTS AVAIL | QTY PER ASSY |
|-------------------------|-----------------|------------------------------------------------------------------------------|-------------|--------------|
|                         |                 | <b>FIXED FLOATS – TUBE ASSEMBLIES INSTALLATION</b>                           |             |              |
| 32-9-1                  | A949-1 *        | Float Tube Assembly* (LH, black. Includes items 2, 3, 25, and 26.) . . . . . | X           | 1            |
|                         | A949-2 *        | Float Tube Assembly* (RH, black. Includes items 2, 3, 25, and 26.) . . . . . | X           | 1            |
| 2                       | 3MA1009-4       | Pressure Relief Valve . . . . .                                              | X           | 4            |
| 3                       | 4RA1190-2       | Hand Pump Fitting (Incl item 4) . . . . .                                    | X           | 4            |
| 4                       | —               | Screw . . . . .                                                              | O           | 4            |
| 5                       | NAS1149F0563P** | Washer . . . . .                                                             | X           | 8            |
| 6                       | NAS6605-5**     | Bolt . . . . .                                                               | X           | 8            |
| 7                       | A945-1          | Skid Extension (LH) . . . . .                                                | X           | 1            |
|                         | A945-2          | Skid Extension (RH) . . . . .                                                | X           | 1            |
| 8                       | A667-5          | Skid Shoe – Straight . . . . .                                               | X           | 2            |
| 9                       | A142-1          | Screw . . . . .                                                              | X           | 12           |
| 10                      | D210-4***       | Nut . . . . .                                                                | X           | 26           |
| 11                      | NAS1149F0432P   | Washer . . . . .                                                             | X           | 56           |
| 12                      | NAS1330H3K116L  | Rivnut . . . . .                                                             | X           | 4            |
| 13                      | A944-2          | Strip . . . . .                                                              | X           | 2            |
| 14                      | A944-1          | Strip (LH) . . . . .                                                         | X           | 1            |
|                         | A944-4          | Strip (RH) . . . . .                                                         | X           | 1            |
| 15                      | A944-3          | Strip (LH and RH) . . . . .                                                  | X           | 2            |
| 16                      | NAS6604-34***   | Bolt . . . . .                                                               | X           | 1            |
| 17                      | NAS6604-32***   | Bolt . . . . .                                                               | X           | 20           |
| 18                      | NAS6604-28***   | Bolt . . . . .                                                               | X           | 5            |
| 19                      | NAS6604-30***   | Bolt . . . . .                                                               | X           | 2            |
| 20                      | B202-1          | Drain Plug Assembly (Incl item 21) . . . . .                                 | X           | 1            |
| 21                      | A215-013        | O-Ring . . . . .                                                             | X           | 1            |
| 22                      | A246-1          | Liner (no longer available; see item 32) . . . . .                           | O           | 2            |
| 23                      | A014-15         | Skid Tube (LH, revision AI and prior. See item 30) . . . . .                 | O           | 1            |
|                         | A242-1          | Skid Tube (LH; see item 31) . . . . .                                        | O           | 1            |
|                         | A014-16         | Skid Tube (RH, revision AI and prior. See item 30) . . . . .                 | O           | 1            |
|                         | A242-2          | Skid Tube (RH; see item 31) . . . . .                                        | O           | 1            |
| 24                      | A667-6          | Skid Shoe – Curved . . . . .                                                 | X           | 1            |
| 25                      | —               | Lacing . . . . .                                                             | O           | 2            |
| 26                      | —               | Restraint Belt . . . . .                                                     | O           | 2            |
| 27                      | A247-1          | Rain Cap (bond in place using item 28) . . . . .                             | X           | 1            |

NOTES \* Top half painted white; specify B900-6 component modification when ordering.  
 \*\* Cover bolt head and washer with item 28.  
 \*\*\* Seal under head and nut with item 28.

Continues

| FIGURE AND INDEX NUMBER                                         | PART NUMBER | DESCRIPTION                                                                                                   | PARTS AVAIL | QTY PER ASSY |
|-----------------------------------------------------------------|-------------|---------------------------------------------------------------------------------------------------------------|-------------|--------------|
| <b>FIXED FLOATS – TUBE ASSEMBLIES INSTALLATION<br/>(Cont'd)</b> |             |                                                                                                               |             |              |
| 32-9-28                                                         | B270-1      | Sealant . . . . .                                                                                             | X           | A/R          |
| 29                                                              | A142-3      | Screw (revision AJ and subsequent) . . . . .                                                                  | X           | 4            |
| 30                                                              | A014-15     | Skid Tube Assembly (LH, revision AJ and subsequent; includes items 8, 9, 12, 24, 27, 29, 31 and 32) . . . . . | X           | 1            |
|                                                                 | A014-16     | Skid Tube Assembly (RH, revision AJ and subsequent; includes items 8, 9, 12, 24, 27, 29, 31 and 32) . . . . . | X           | 1            |
| 31                                                              | A943-5      | Skid Tube (LH, revision U and subsequent. See item 30.) . . .                                                 | O           | 1            |
|                                                                 | A943-6      | Skid Tube (RH, revision U and subsequent. See item 30.) . . .                                                 | O           | 1            |
| 32                                                              | A246-5      | Liner (LH; revision AJ and subsequent) . . . . .                                                              | X           | 1            |
|                                                                 | A246-6      | Liner (RH; revision AJ and subsequent) . . . . .                                                              | X           | 1            |
| 33                                                              | MT340-1     | Float Gauge and Fill Gun Kit (not shown) . . . . .                                                            | X           | 1            |
| 34                                                              | KI-83-1     | Float Repair Kit (not shown) . . . . .                                                                        | X           | 1            |
| 35                                                              | A034-1      | Float Landing Gear Assembly (Incl items 1 thru 27) . . . . .                                                  | X           | 1            |

NOTES