

R44 SERVICE LETTER SL-41

DATE: 07 September 2011

TO: R44 and R44 II owners, operators, and maintenance personnel

SUBJECT: Ground Handling Wheels and Wheel Supports

BACKGROUND: C063-1 ground handling wheels are no longer available from the factory. Wheel supports on production helicopters are oriented for C063-5 (LH) and C063-6 (RH) ground handling wheels, installed inboard of landing gear skid tubes. New wheels may be used on earlier R44 helicopters when the wheel supports are rotated 180°. Earlier wheels may be modified for inboard installation.

COMPLIANCE PROCEDURE:

A. To rotate ground handling wheel supports 180°:

1. Refer to R44 Illustrated Parts Catalog (IPC) Figure 3-1. Remove hardware securing C719-1 support to landing gear skid tube and remove support. Thoroughly clean and visually inspect support, and skid tube at support attachment.
2. Refer to Figure 1. Orient support with tall plate inboard and install original hardware, but with bolt heads inboard for tire clearance. Special torque nuts to 70 in.-lb and torque stripe per R44 Maintenance Manual (MM) Figure 2-1. Repeat steps for opposite support.

B. To modify earlier ground handling wheels:

1. Order KI-210 kit from RHC Customer Service.
2. Refer to IPC Figure 3-7. Remove cotter pin and nut securing C717 shaft assembly to wheel. Pull shaft assembly, with attached C718 lever assembly, from wheel.
3. Remove hardware securing lever to shaft.
4. Refer to Figure 2. Install hardware securing C717-7 plate to lever and shaft. Special torque nuts to 70 in.-lb and torque stripe per MM Figure 2-1.
5. As required, pack wheel cavity and bearings with new A257-5 grease. Insert shaft assembly in wheel and install nut. Special torque nut to 30 in.-lb, then loosen nut to nearest castellation, and install cotter pin. Repeat steps for opposite wheel.

(OVER)

Approximate Cost:

Parts: None required, to rotate ground handling wheel supports 180°.

\$90.30 for KI-210, to modify earlier ground handling wheels. KI-210 includes C717-7 plates, MS24665-285 cotter pins, NAS6603-4 bolts, NAS6603-12 bolts, NAS620-10L washers, NAS1149F0332P washers, NAS1149F0363P washers, and MS21042L3 nuts.

Labor: 1.0 man-hour.

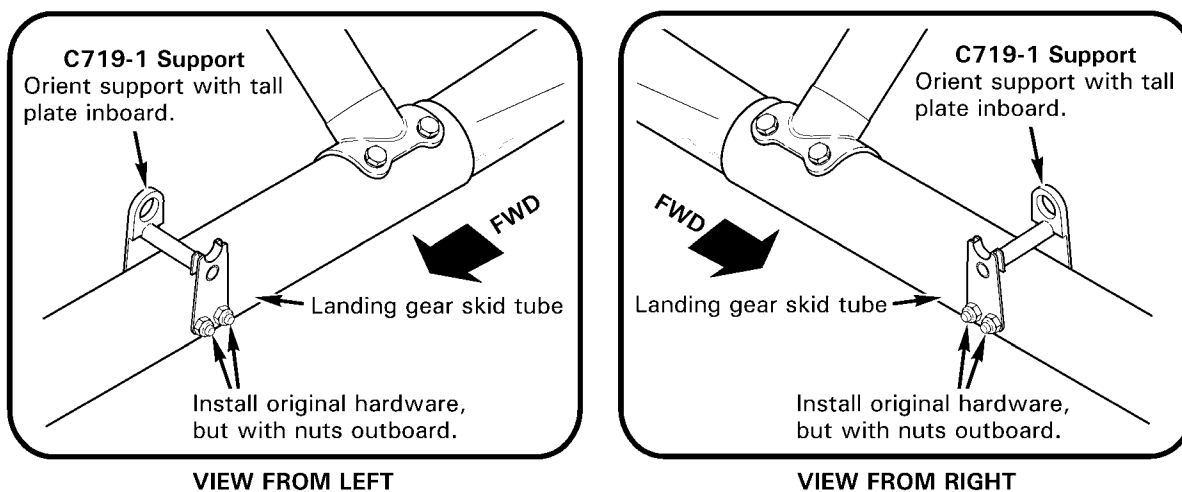

FIGURE 1

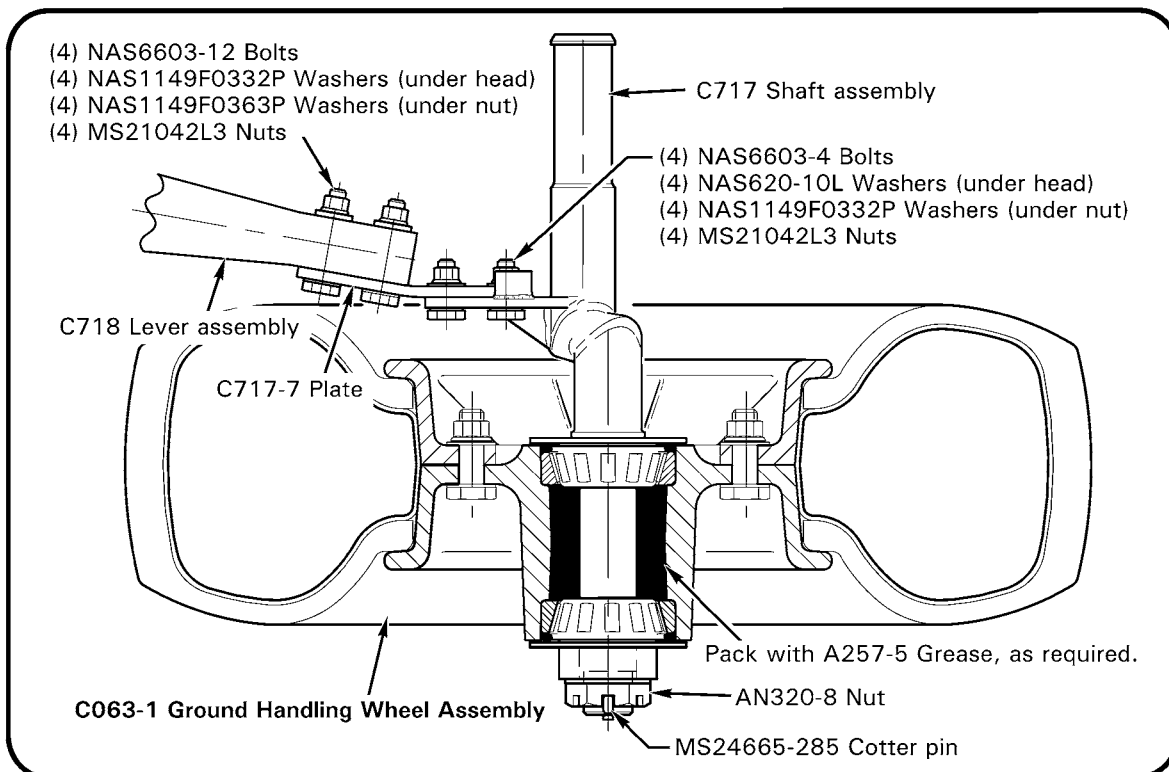

FIGURE 2